

ELENCO PARTI / PARTS LIST

#	QTÀ / QTY	DESCRIZIONE / DESCRIPTION	CODICE / CODE
1	1	DB killer / DB killer	50.DK.092.0
2	1	Silenziatore / Muffler	OVAL 360
3	1	Protezione in gomma / Rubber protection	50.73.077.1
4	1	Staffa / Bracket	50.SS.031.0
5	2	Vite M6 x 12 / Screw M6 x 12	50.72.024.1
6	4	Rondella M6 / Washer M6	50.72.027.1
7	2	Dado M6 / Nut M6	50.73.146.1
8	1	Dado M10 flangiato / Flanged nut M10	50.73.332.1
9	1	Vite M10x45 / Screw M10x45	50.73.888.1
10	1	Rondella in alluminio nera / Black aluminium washer	50.73.330.1
11	1	Fascetta Ø 44/47 mm / Pipe clamp Ø 44/47 mm	50.FA.006.1
12	1	Tubo di raccordo / Link pipe	9773Y06453
13	1	Fascetta con bussola / Pipe clamp with bush	50.73.915.0
14	1	Dado rapido M6 / Cage nut M6	50.66.009.1
15	1	Fascetta / Pipe clamp	50.73.916.0
16	1	Tubo in gomma per molla / Rubber pipe for spring	50.73.049.0
17	1	Molla media / Mid-size spring	50.73.359.1

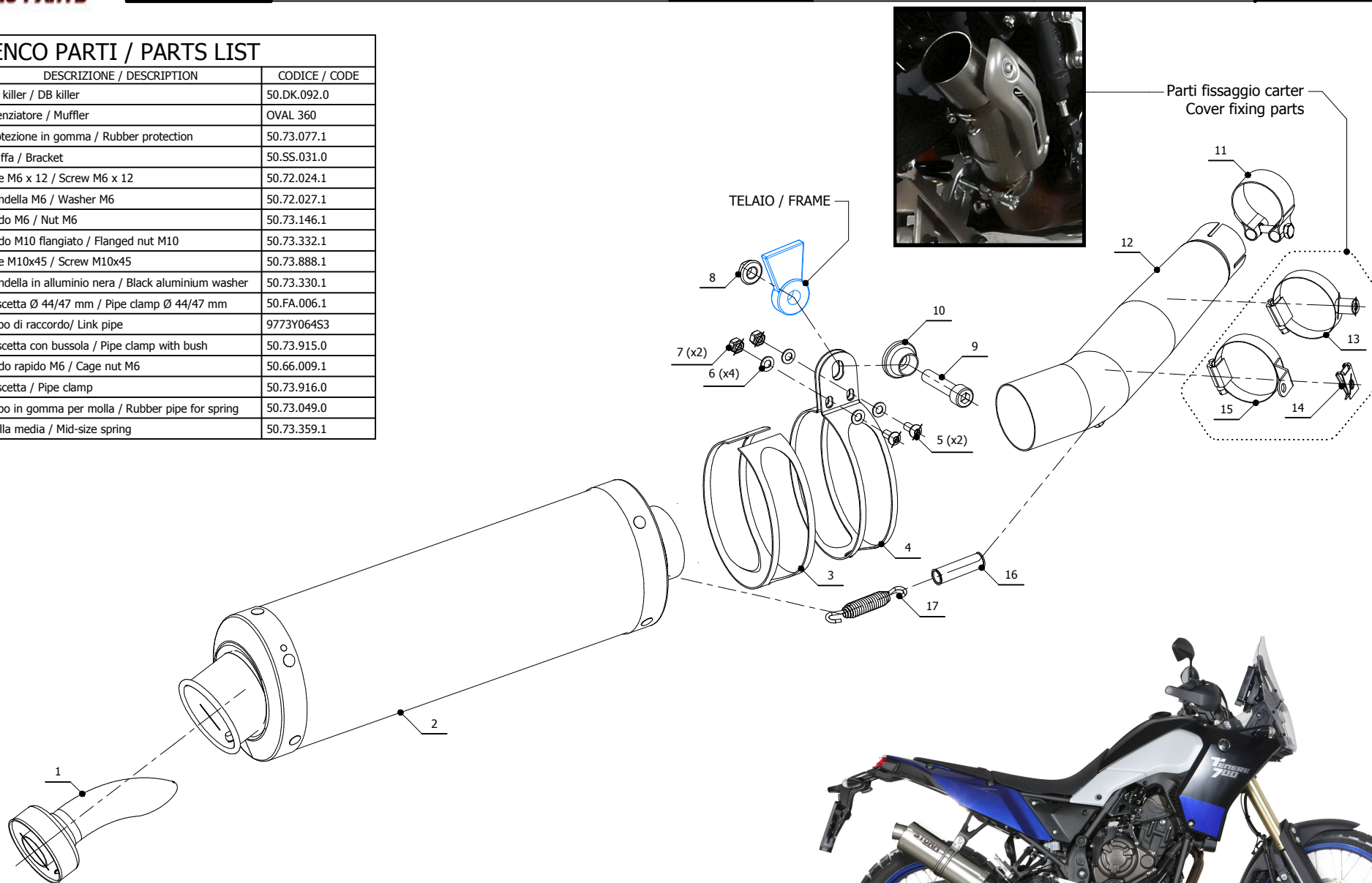

APPLICAZIONI / APPLICATIONS

CODICE / CODE	SILENZIATORE / MUFFLER	TUBO / PIPE	FASCETTA / CLAMP
74.Y.064.LX1	INOX / ST.STEEL	INOX / ST.STEEL	INOX / ST.STEEL
74.Y.064.LX1B	STEEL BLACK		